

Filters and ball check valves

Current version

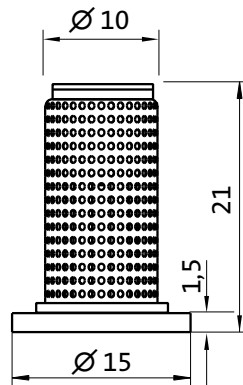

Fits on most older nozzle holders not conform to ISO 8169

New design

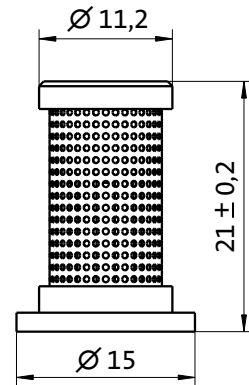

New! Fits on all nozzle holders conform to ISO 8169

Current version



Strainer F

Part no.	Mesh	Colour
116F24M	24 M	white
116F50M	50 M	blue
116F100M	100 M	red



Ball valves KV

Part no.	Opening pressure	Colour
116KV03	0.3 bar	blue/white
116KV07	0.7 bar	blue/red
116KV28	2.8 bar	blue/green



Ball check strainers KVF

Part no.	Opening pressure	Mesh	Colour
116KVF24M03	0.3 bar	24 M	white/white
116KVF24M07	0.7 bar	24 M	white/red
116KVF24M28	2.8 bar	24 M	white/green



Part no.	Opening pressure	Mesh	Colour
116KVF50M03	0.3 bar	50 M	blue/white
116KVF50M07	0.7 bar	50 M	blue/red
116KVF50M28	2.8 bar	50 M	blue/green



Part no.	Opening pressure	Mesh	Colour
116KVF100M03	0.3 bar	100 M	red/white
116KVF100M07	0.7 bar	100 M	red/red
116KVF100M28	2.8 bar	100 M	red/green



Colour-coated bottom indicates opening pressure		
white = 0.3 bar (4 psi)	red = 0.7 bar (10 psi)	green = 2.8 bar (40 psi)

New design



Current colour codes not ISO standardised.
New ISO colour codes will be introduced following production plan.

Cup filter

Part no.	Type	Colour
0054242302	stainless steel 32 mesh	red
0054242303	stainless steel 50 mesh	blue
00542423035	stainless steel 80 mesh	yellow
0054242304	stainless steel 100 mesh	green

Slotted filter, plastic

Part no.	Mesh	Colour
014735089	ca. 24 M	black
07750987	ca. 50 M	blue

Strainer F

Part no.	Mesh	Colour bottom/top
116NF24M	24 M	white/black
116NF50M	50 M	blue/black
116NF100M	100 M	red/black
116NF200M	200 M	green/black

Ball valves KV

Part no.	Opening pressure	Colour bottom/top
116NKV03	0.3 bar	blue/white
116NKV07	0.7 bar	blue/red
116NKV28	2.8 bar	blue/green

Ball check strainers KVF

Part no.	Opening pressure	Mesh	Colour bottom/top
116NKVF24M03	0.3 bar	24 M	white/white
116NKVF24M07	0.7 bar	24 M	white/red
116NKVF24M28	2.8 bar	24 M	white/green

Part no.	Opening pressure	Mesh	Colour bottom/top
116NKVF50M03	0.3 bar	50 M	blue/white
116NKVF50M07	0.7 bar	50 M	blue/red
116NKVF50M28	2.8 bar	50 M	blue/green

Part no.	Opening pressure	Mesh	Colour bottom/top
116NKVF100M03	0.3 bar	100 M	red/white
116NKVF100M07	0.7 bar	100 M	red/red
116NKVF100M28	2.8 bar	100 M	red/green

Part no.	Opening pressure	Mesh	Colour bottom/top
116NKVF200M03	0.3 bar	200 M	green/white
116NKVF200M07	0.7 bar	200 M	green/red
116NKVF200M28	2.8 bar	200 M	green/green

Colour-coated top indicates opening pressure

white = 0.3 bar (4 psi) red = 0.7 bar (10 psi) green = 2.8 bar (40 psi)